



MÁS TUBERÍAS Y ACEROS DE TOLUCA

722 508 0577 - 722 208 6618
 mastuberiasyaceros@gmail.com
 mastuberiasyacerosdetoluca.com.mx



CONEXIONES SANITARIAS SOLDABLES E INOXIDABLES

Codos de 90° Extremos Soldables Tipo 304 / 316L **2WC**

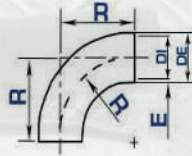
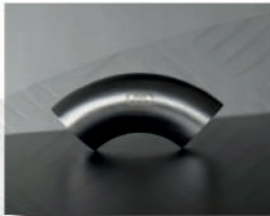

CLAVE	TAMANO NOMINAL	DE		DI		E		R	
		inche	mm	inche	mm	inche	mm	inche	mm
DMI 2WC 5	1/2"	0.500"	12.70	0.370"	9.40	0.065"	1.65	0.750"	19.05
DMI 2WC 7	3/4"	0.750"	19.05	0.620"	15.75	0.065"	1.65	1.125"	28.58
DMI 2WC 10	1"	1.000"	25.40	0.870"	22.10	0.065"	1.65	1.500"	38.10
DMI 2WC 15	1-1/2"	1.500"	38.10	1.370"	34.80	0.065"	1.65	2.250"	57.15
DMI 2WC 20	2"	2.000"	50.80	1.870"	47.50	0.065"	1.65	3.000"	76.20
DMI 2WC 25	2-1/2"	2.500"	63.50	2.370"	60.20	0.065"	1.65	3.750"	95.25
DMI 2WC 30	3"	3.000"	76.20	2.870"	72.90	0.065"	1.65	4.500"	114.30
DMI 2WC 40	4"	4.000"	101.60	3.834"	97.38	0.083"	2.11	6.000"	152.40
DMI 2WC 60	6"	6.000"	152.40	5.782"	146.86	0.109"	2.77	9.000"	228.60

Codos de 90° Extremos CLAMP Tipo 304 / 316L **2CMP**

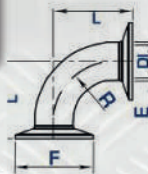
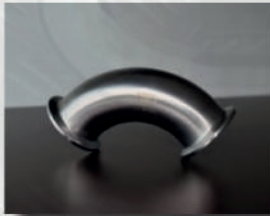

CLAVE	TAMANO NOMINAL	DE		DI		E		R		L		F	
		inche	mm	inche	mm	inche	mm	inche	mm	inche	mm	inche	mm
DMI 2CMP 5	1/2"	0.500"	12.70	0.370"	9.40	0.065"	1.65	0.750"	19.05	1.250"	31.75	1.000"	25.40
DMI 2CMP 7	3/4"	0.750"	19.05	0.620"	15.75	0.065"	1.65	1.125"	28.58	1.625"	41.28	1.000"	25.40
DMI 2CMP 10	1"	1.000"	25.40	0.870"	22.10	0.065"	1.65	1.500"	38.10	2.000"	50.80	1.984"	50.39
DMI 2CMP 15	1-1/2"	1.500"	38.10	1.370"	34.80	0.065"	1.65	2.250"	57.15	2.750"	69.85	1.984"	50.39
DMI 2CMP 20	2"	2.000"	50.80	1.870"	47.50	0.065"	1.65	3.000"	76.20	3.500"	88.90	2.516"	63.91
DMI 2CMP 25	2-1/2"	2.500"	63.50	2.370"	60.20	0.065"	1.65	3.750"	95.25	4.250"	107.95	3.047"	77.39
DMI 2CMP 30	3"	3.000"	76.20	2.870"	72.90	0.065"	1.65	4.500"	114.30	5.000"	127.00	3.579"	90.91
DMI 2CMP 40	4"	4.000"	101.60	3.834"	97.38	0.083"	2.11	6.000"	152.40	6.625"	168.28	4.662"	118.92
DMI 2CMP 60	6"	6.000"	152.40	5.782"	146.86	0.109"	2.77	9.000"	228.60	9.875"	250.83	6.571"	166.90

Codos de 45° Extremos Soldables Tipo 304 / 316L **2WK**

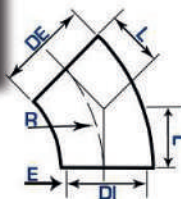
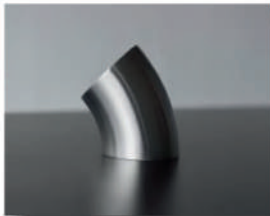

CLAVE	TAMANO NOMINAL	DE		DI		E		R		L	
		inche	mm	inche	mm	inche	mm	inche	mm	inche	mm
DMI 2WK 5	1/2"	0.500"	12.70	0.370"	9.40	0.065"	1.65	0.750"	19.05	0.307"	7.80
DMI 2WK 7	3/4"	0.750"	19.05	0.620"	15.75	0.065"	1.65	1.125"	28.58	0.469"	11.90
DMI 2WK 10	1"	1.000"	25.40	0.870"	22.10	0.065"	1.65	1.500"	38.10	0.628"	15.90
DMI 2WK 15	1-1/2"	1.500"	38.10	1.370"	34.80	0.065"	1.65	2.250"	57.15	0.937"	23.80
DMI 2WK 20	2"	2.000"	50.80	1.870"	47.50	0.065"	1.65	3.000"	76.20	1.250"	31.75
DMI 2WK 25	2-1/2"	2.500"	63.50	2.370"	60.20	0.065"	1.65	3.750"	95.25	1.563"	39.70
DMI 2WK 30	3"	3.000"	76.20	2.870"	72.90	0.065"	1.65	4.500"	114.30	1.874"	47.80
DMI 2WK 40	4"	4.000"	101.60	3.834"	97.38	0.083"	2.11	6.000"	152.40	2.500"	63.50
DMI 2WK 60	6"	6.000"	152.40	5.782"	146.86	0.109"	2.77	9.000"	228.60	3.752"	95.30



MÁS TUBERÍAS Y ACEROS DE TOLUCA

722 508 0577 - 722 208 6618
 mastuberiasyaceros@gmail.com
 mastuberiasyacerosdetoluca.com.mx



CONEXIONES SANITARIAS SOLDABLES E INOXIDABLES

2KMP

Codos de 45° Extremos CLAMP Tipo 304 / 316L



CLAVE	TAMANO NOMINAL	DE mm	DI mm	E mm	R mm	L mm	F mm
DMI 2KMP 5	1/2"	0.500"	0.370"	0.065"	0.750"	1.000"	1.000"
DMI 2KMP 7	3/4"	0.750"	0.620"	0.065"	1.125"	1.000"	1.000"
DMI 2KMP 10	1"	1.000"	0.870"	0.065"	1.500"	1.125"	1.984"
DMI 2KMP 15	1-1/2"	1.500"	1.370"	0.065"	2.250"	1.440"	1.984"
DMI 2KMP 20	2"	2.000"	1.870"	0.065"	3.000"	1.750"	2.516"
DMI 2KMP 25	2-1/2"	2.500"	2.370"	0.065"	3.750"	2.060"	3.047"
DMI 2KMP 30	3"	3.000"	2.870"	0.065"	4.500"	2.380"	3.578"
DMI 2KMP 40	4"	4.000"	3.834"	0.083"	6.000"	3.125"	4.682"
DMI 2KMP 60	6"	6.000"	5.782"	0.109"	9.000"	4.625"	6.571"

7W

Te Recta Extremos Soldables Tipo 304 / 316L

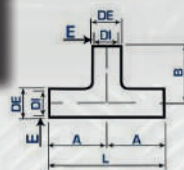

CLAVE	TAMANO NOMINAL	DE mm	DI mm	E mm	A mm	B mm	L mm
DMI 7W 5	1/2"	0.500"	0.370"	0.065"	1.875"	1.875"	3.750"
DMI 7W 7	3/4"	0.750"	0.620"	0.065"	1.875"	1.875"	3.750"
DMI 7W 10	1"	1.000"	0.870"	0.065"	1.875"	1.875"	3.750"
DMI 7W 15	1-1/2"	1.500"	1.370"	0.065"	2.250"	2.250"	4.500"
DMI 7W 20	2"	2.000"	1.870"	0.065"	3.000"	3.000"	6.000"
DMI 7W 25	2-1/2"	2.500"	2.370"	0.065"	3.000"	3.000"	6.000"
DMI 7W 30	3"	3.000"	2.870"	0.065"	3.250"	3.250"	6.500"
DMI 7W 40	4"	4.000"	3.834"	0.083"	3.875"	3.875"	7.750"
DMI 7W 60	6"	6.000"	5.782"	0.109"	5.000"	5.000"	10.000"

7MP

Te Recta Extremos CLAMP Tipo 304 / 316L

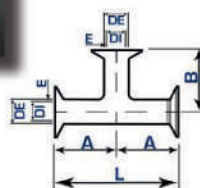

CLAVE	TAMANO NOMINAL	DE mm	DI mm	E mm	A mm	B mm	L mm
DMI 7MP 5	1/2"	0.500"	0.370"	0.065"	1.250"	1.250"	4.500"
DMI 7MP 7	3/4"	0.750"	0.620"	0.065"	1.375"	1.375"	4.750"
DMI 7MP 10	1"	1.000"	0.870"	0.065"	1.500"	1.500"	4.750"
DMI 7MP 15	1-1/2"	1.500"	1.370"	0.065"	1.750"	1.750"	5.500"
DMI 7MP 20	2"	2.000"	1.870"	0.065"	1.875"	1.875"	7.000"
DMI 7MP 25	2-1/2"	2.500"	2.370"	0.065"	1.875"	1.875"	7.000"
DMI 7MP 30	3"	3.000"	2.870"	0.065"	1.875"	1.875"	7.000"
DMI 7MP 40	4"	4.000"	3.834"	0.083"	2.125"	2.125"	9.000"
DMI 7MP 60	6"	6.000"	5.782"	0.109"	2.777"	2.777"	11.750"



MÁS TUBERÍAS Y ACEROS DE TOLUCA

722 508 0577 - 722 208 6618
 mastuberiasyaceros@gmail.com
 mastuberiasyacerosdetoluca.com.mx



CONEXIONES SANITARIAS SOLDABLES E INOXIDABLES

Codo 90° Radio Largo L2S
 Tipo 304 / 316L

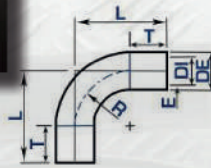

CLAVE	TAMAÑO NOMINAL	DE	DI	E	R	T	L						
		mm	mm	mm	mm	mm	mm						
DMI L2S 10	1"	1.000"	25.40	0.870"	22.10	0.065"	1.65	1.500"	38.10	0.960"	14.22	2.090"	52.32
DMI L2S 15	1-1/2"	1.500"	38.10	1.370"	34.80	0.065"	1.65	2.250"	57.15	0.860"	17.53	2.940"	74.68
DMI L2S 20	2"	2.000"	50.80	1.870"	47.50	0.065"	1.65	3.000"	76.20	1.060"	26.92	4.080"	103.12
DMI L2S 25	2-1/2"	2.500"	63.50	2.370"	60.20	0.065"	1.65	3.750"	95.25	1.440"	36.58	5.190"	131.83
DMI L2S 30	3"	3.000"	76.20	2.870"	72.90	0.065"	1.65	4.500"	114.30	1.810"	45.97	6.310"	160.27
DMI L2S 40	4"	4.000"	101.60	3.834"	97.38	0.083"	2.11	6.000"	152.40	2.310"	58.67	8.310"	211.07

Cruz Soldable 9W
 Tipo 304

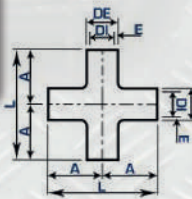

CLAVE	TAMAÑO NOMINAL	DE	DI	E	A	L	
		mm	mm	mm	mm	mm	
DMI 9W 5	1/2"	0.500"	12.70	0.370"	9.40	3.750"	95.25
DMI 9W 7	3/4"	0.750"	19.05	0.620"	15.75	3.750"	95.25
DMI 9W 10	1"	1.000"	25.40	0.870"	22.10	3.750"	95.25
DMI 9W 15	1-1/2"	1.500"	38.10	1.370"	34.80	2.250"	57.15
DMI 9W 20	2"	2.000"	50.80	1.870"	47.50	3.000"	76.20
DMI 9W 25	2-1/2"	2.500"	63.50	2.370"	60.20	3.000"	76.20
DMI 9W 30	3"	3.000"	76.20	2.870"	72.90	3.250"	82.55
DMI 9W 40	4"	4.000"	101.60	3.834"	97.38	3.675"	96.43
DMI 9W 60	6"	6.000"	152.40	5.782"	146.88	0.109"	2.77

Cruz CLAMP 9MP
 Tipo 304

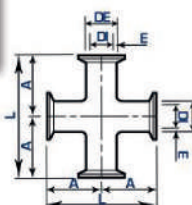

CLAVE	TAMAÑO NOMINAL	DE	DI	E	A	L	
		mm	mm	mm	mm	mm	
DMI 9MP 5	1/2"	0.500"	12.70	0.370"	9.40	2.250"	57.15
DMI 9MP 7	3/4"	0.750"	19.05	0.620"	15.75	2.375"	60.33
DMI 9MP 10	1"	1.000"	25.40	0.870"	22.10	2.375"	60.33
DMI 9MP 15	1-1/2"	1.500"	38.10	1.370"	34.80	0.065"	1.65
DMI 9MP 20	2"	2.000"	50.80	1.870"	47.50	0.065"	1.65
DMI 9MP 25	2-1/2"	2.500"	63.50	2.370"	60.20	0.065"	1.65
DMI 9MP 30	3"	3.000"	76.20	2.870"	72.90	0.065"	1.65
DMI 9MP 40	4"	4.000"	101.60	3.834"	97.38	0.083"	2.11
DMI 9MP 60	6"	6.000"	152.40	5.782"	146.88	0.109"	2.77



CONEXIONES SANITARIAS SOLDABLES E INOXIDABLES

31W

Reducción Concéntrica Soldable
 Tipo 304 / 316L

CLAVE	TAMAÑO NOMINAL	DE1		DI1		E1		DE2		DI2		E2		L	
		inche	mm	inche	mm	inche	mm	inche	mm	inche	mm	inche	mm	inche	mm
DMI 31W 7X5	3/4" x 1/2"	0.500"	12.70	0.370"	9.40	0.065"	1.65	0.500"	12.70	0.370"	9.40	0.065"	1.65	1.000"	25.40
DMI 31W 10X5	1" x 1/2"	1.000"	25.40	0.870"	22.10	0.065"	1.65	0.500"	12.70	0.370"	9.40	0.065"	1.65	1.000"	25.40
DMI 31W 10X7	1 x 3/4"	1.000"	25.40	0.870"	22.10	0.065"	1.65	0.750"	19.05	0.620"	15.75	0.065"	1.65	1.000"	25.40
DMI 31W 15X5	1-1/2" x 1/2"	1.500"	38.10	1.370"	34.80	0.065"	1.65	0.500"	12.70	0.370"	9.40	0.065"	1.65	2.500"	63.50
DMI 31W 15X7	1-1/2" x 3/4"	1.500"	38.10	1.370"	34.80	0.065"	1.65	0.750"	19.05	0.620"	15.75	0.065"	1.65	2.000"	50.80
DMI 31W 15X10	1-1/2" x 1"	1.500"	38.10	1.370"	34.80	0.065"	1.65	1.000"	25.40	0.870"	22.10	0.065"	1.65	2.000"	50.80
DMI 31W 20X5	2" x 1/2"	2.000"	50.80	1.870"	47.50	0.065"	1.65	0.500"	12.70	0.370"	9.40	0.065"	1.65	4.500"	114.30
DMI 31W 20X7	2" x 3/4"	2.000"	50.80	1.870"	47.50	0.065"	1.65	0.750"	19.05	0.620"	15.75	0.065"	1.65	4.000"	101.60
DMI 31W 20X10	2" x 1"	2.000"	50.80	1.870"	47.50	0.065"	1.65	1.000"	25.40	0.870"	22.10	0.065"	1.65	4.000"	101.60
DMI 31W 20X15	2" x 1-1/2"	2.000"	50.80	1.870"	47.50	0.065"	1.65	1.500"	38.10	1.370"	34.80	0.065"	1.65	2.000"	50.80
DMI 31W 25X5	2-1/2" x 1/2"	2.500"	63.50	2.370"	60.20	0.065"	1.65	0.500"	12.70	0.370"	9.40	0.065"	1.65	6.500"	165.10
DMI 31W 25X7	2-1/2" x 3/4"	2.500"	63.50	2.370"	60.20	0.065"	1.65	0.750"	19.05	0.620"	15.75	0.065"	1.65	6.000"	152.40
DMI 31W 25X10	2-1/2" x 1"	2.500"	63.50	2.370"	60.20	0.065"	1.65	1.000"	25.40	0.870"	22.10	0.065"	1.65	6.000"	152.40
DMI 31W 25X15	2-1/2" x 1-1/2"	2.500"	63.50	2.370"	60.20	0.065"	1.65	1.500"	38.10	1.370"	34.80	0.065"	1.65	4.000"	101.60
DMI 31W 25X20	2-1/2" x 2"	2.500"	63.50	2.370"	60.20	0.065"	1.65	2.000"	50.80	1.870"	47.50	0.065"	1.65	2.000"	50.80
DMI 31W 30X5	3" x 1/2"	3.000"	76.20	2.870"	72.90	0.065"	1.65	0.500"	12.70	0.370"	9.40	0.065"	1.65	8.500"	215.90
DMI 31W 30X7	3" x 3/4"	3.000"	76.20	2.870"	72.90	0.065"	1.65	0.750"	19.05	0.620"	15.75	0.065"	1.65	8.000"	203.20
DMI 31W 30X10	3" x 1"	3.000"	76.20	2.870"	72.90	0.065"	1.65	1.000"	25.40	0.870"	22.10	0.065"	1.65	8.000"	203.20
DMI 31W 30X15	3" x 1-1/2"	3.000"	76.20	2.870"	72.90	0.065"	1.65	1.500"	38.10	1.370"	34.80	0.065"	1.65	6.000"	152.40
DMI 31W 30X20	3" x 2"	3.000"	76.20	2.870"	72.90	0.065"	1.65	2.000"	50.80	1.870"	47.50	0.065"	1.65	4.000"	101.60
DMI 31W 30X25	3" x 2-1/2"	3.000"	76.20	2.870"	72.90	0.065"	1.65	2.500"	63.50	2.370"	60.20	0.065"	1.65	2.000"	50.80
DMI 31W 40X10	4" x 1"	4.000"	101.60	3.834"	97.38	0.083"	2.11	1.000"	25.40	0.870"	22.10	0.065"	1.65	12.000"	304.80
DMI 31W 40X15	4" x 1-1/2"	4.000"	101.60	3.834"	97.38	0.083"	2.11	1.500"	38.10	1.370"	34.80	0.065"	1.65	10.000"	254.00
DMI 31W 40X20	4" x 2"	4.000"	101.60	3.834"	97.38	0.083"	2.11	2.000"	50.80	1.870"	47.50	0.065"	1.65	8.000"	203.20
DMI 31W 40X25	4" x 2-1/2"	4.000"	101.60	3.834"	97.38	0.083"	2.11	2.500"	63.50	2.370"	60.20	0.065"	1.65	6.000"	152.40
DMI 31W 40X30	4" x 3"	4.000"	101.60	3.834"	97.38	0.083"	2.11	3.000"	76.20	2.870"	72.90	0.065"	1.65	4.000"	101.60
DMI 31W 60X20	6" x 2"	6.000"	152.40	5.782"	146.86	0.109"	2.77	2.000"	50.80	1.870"	47.50	0.065"	1.65	5.500"	139.70
DMI 31W 60X30	6" x 3"	6.000"	152.40	5.782"	146.86	0.109"	2.77	3.000"	76.20	2.870"	72.90	0.065"	1.65	5.500"	139.70
DMI 31W 60X40	6" x 4"	6.000"	152.40	5.782"	146.86	0.109"	2.77	4.000"	101.60	3.834"	97.38	0.083"	2.11	5.500"	139.70

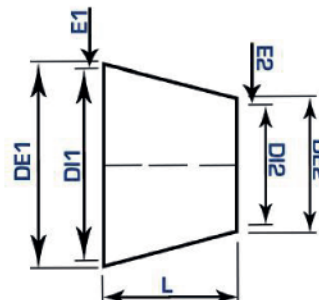



CONEXIONES SANITARIAS SOLDABLES E INOXIDABLES

Reducción Concéntrica CLAMP Tipo 304 / 316L **3114MP**

CLAVE	TAMAÑO NOMINAL	DE1		DI1		E1		DE2		DI2		E2		L	
		inche	mm	inche	mm	inche	mm	inche	mm	inche	mm	inche	mm	inche	mm
DMI 3114MP 7X5	3/4" x 1/2"	0.500"	12.70	0.370"	9.40	0.065"	1.65	0.500"	12.70	0.370"	9.40	0.065"	1.65	2.000"	50.80
DMI 3114MP 10X5	1" x 1/2"	1.000"	25.40	0.870"	22.10	0.065"	1.65	0.500"	12.70	0.370"	9.40	0.065"	1.65	2.500"	63.50
DMI 3114MP 10X7	1 x 3/4"	1.000"	25.40	0.870"	22.10	0.065"	1.65	0.750"	19.05	0.620"	15.75	0.065"	1.65	2.000"	50.80
DMI 3114MP 15X5	1 - 1/2" x 1/2"	1.500"	38.10	1.370"	34.80	0.065"	1.65	0.500"	12.70	0.370"	9.40	0.065"	1.65	3.500"	88.90
DMI 3114MP 15X7	1 - 1/2" x 3/4"	1.500"	38.10	1.370"	34.80	0.065"	1.65	0.750"	19.05	0.620"	15.75	0.065"	1.65	3.000"	76.20
DMI 3114MP 15X10	1 - 1/2" x 1"	1.500"	38.10	1.370"	34.80	0.065"	1.65	1.000"	25.40	0.870"	22.10	0.065"	1.65	3.000"	76.20
DMI 3114MP 20X5	2" x 1/2"	2.000"	50.80	1.870"	47.50	0.065"	1.65	0.500"	12.70	0.370"	9.40	0.065"	1.65	5.500"	139.70
DMI 3114MP 20X7	2" x 3/4"	2.000"	50.80	1.870"	47.50	0.065"	1.65	0.750"	19.05	0.620"	15.75	0.065"	1.65	5.000"	127.00
DMI 3114MP 20X10	2" x 1"	2.000"	50.80	1.870"	47.50	0.065"	1.65	1.000"	25.40	0.870"	22.10	0.065"	1.65	5.000"	127.00
DMI 3114MP 20X15	2" x 1-1/2"	2.000"	50.80	1.870"	47.50	0.065"	1.65	1.500"	38.10	1.370"	34.80	0.065"	1.65	3.000"	76.20
DMI 3114MP 25X10	2 - 1/2" x 1"	2.500"	63.50	2.370"	60.20	0.065"	1.65	1.000"	25.40	0.870"	22.10	0.065"	1.65	7.000"	177.80
DMI 3114MP 25X15	2 - 1/2" x 1-1/2"	2.500"	63.50	2.370"	60.20	0.065"	1.65	1.500"	38.10	1.370"	34.80	0.065"	1.65	5.000"	127.00
DMI 3114MP 25X20	2 - 1/2" x 2"	2.500"	63.50	2.370"	60.20	0.065"	1.65	2.000"	50.80	1.870"	47.50	0.065"	1.65	3.000"	76.20
DMI 3114MP 30X10	3" x 1"	3.000"	76.20	2.870"	72.90	0.065"	1.65	1.000"	25.40	0.370"	9.40	0.065"	1.65	9.000"	228.60
DMI 3114MP 30X15	3" x 1-1/2"	3.000"	76.20	2.870"	72.90	0.065"	1.65	1.500"	38.10	1.370"	34.80	0.065"	1.65	7.000"	177.80
DMI 3114MP 30X20	3" x 2"	3.000"	76.20	2.870"	72.90	0.065"	1.65	2.000"	50.80	1.870"	47.50	0.065"	1.65	5.000"	127.00
DMI 3114MP 30X25	3" x 2-1/2"	3.000"	76.20	2.870"	72.90	0.065"	1.65	2.500"	63.50	2.370"	60.20	0.065"	1.65	3.000"	76.20
DMI 3114MP 40X10	4" x 1"	4.000"	101.60	3.834"	97.38	0.083"	2.11	1.000"	25.40	0.870"	22.10	0.065"	1.65	13.125"	333.38
DMI 3114MP 40X15	4" x 1-1/2"	4.000"	101.60	3.834"	97.38	0.083"	2.11	1.500"	38.10	1.370"	34.80	0.065"	1.65	11.125"	282.58
DMI 3114MP 40X20	4" x 2"	4.000"	101.60	3.834"	97.38	0.083"	2.11	2.000"	50.80	1.870"	47.50	0.065"	1.65	9.125"	231.78
DMI 3114MP 40X25	4" x 2-1/2"	4.000"	101.60	3.834"	97.38	0.083"	2.11	2.500"	63.50	2.370"	60.20	0.065"	1.65	7.125"	180.98
DMI 3114MP 40X30	4" x 3"	4.000"	101.60	3.834"	97.38	0.083"	2.11	3.000"	76.20	2.870"	72.90	0.065"	1.65	5.125"	130.18
DMI 3114MP 60X30	6" x 3"	6.000"	152.40	5.782"	146.86	0.109"	2.77	3.000"	76.20	2.870"	72.90	0.065"	1.65	7.500"	190.50
DMI 3114MP 60X40	6" x 4"	6.000"	152.40	5.782"	146.86	0.109"	2.77	4.000"	101.60	3.834"	97.38	0.083"	2.11	7.625"	193.68

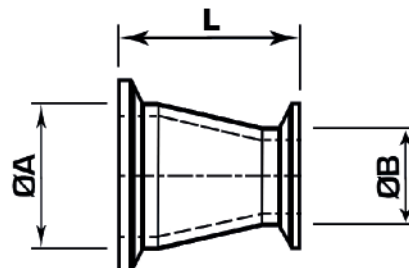



CONEXIONES SANITARIAS SOLDABLES E INOXIDABLES

DMI 32W

Reducción Excéntrica
 Tipo 304 / 316L

CLAVE	TAMAÑO NOMINAL	DE1		DI1		E1		DE2		DI2		E2		L	
		inche	mm	inche	mm	inche	mm	inche	mm	inche	mm	inche	mm	inche	mm
DMI 32W 7X5	3/4" x 1/2"	0.500"	12.70	0.370"	9.40	0.065"	1.65	0.500"	12.70	0.370"	9.40	0.065"	1.65	1.000"	25.40
DMI 32W 10X5	1" x 1/2"	1.000"	25.40	0.870"	22.10	0.065"	1.65	0.500"	12.70	0.370"	9.40	0.065"	1.65	1.000"	25.40
DMI 32W 10X7	1 x 3/4"	1.000"	25.40	0.870"	22.10	0.065"	1.65	0.750"	19.05	0.620"	15.75	0.065"	1.65	1.000"	25.40
DMI 32W 15X5	1 - 1/2" x 1/2"	1.500"	38.10	1.370"	34.80	0.065"	1.65	0.500"	12.70	0.370"	9.40	0.065"	1.65	2.500"	63.50
DMI 32W 15X7	1 - 1/2" x 3/4"	1.500"	38.10	1.370"	34.80	0.065"	1.65	0.750"	19.05	0.620"	15.75	0.065"	1.65	2.000"	50.80
DMI 32W 15X10	1 - 1/2" x 1"	1.500"	38.10	1.370"	34.80	0.065"	1.65	1.000"	25.40	0.870"	22.10	0.065"	1.65	2.000"	50.80
DMI 32W 20X5	2" x 1/2"	2.000"	50.80	1.870"	47.50	0.065"	1.65	0.500"	12.70	0.370"	9.40	0.065"	1.65	4.500"	114.30
DMI 32W 20X7	2" x 3/4"	2.000"	50.80	1.870"	47.50	0.065"	1.65	0.750"	19.05	0.620"	15.75	0.065"	1.65	4.000"	101.60
DMI 32W 20X10	2" x 1"	2.000"	50.80	1.870"	47.50	0.065"	1.65	1.000"	25.40	0.870"	22.10	0.065"	1.65	4.000"	101.60
DMI 32W 20X15	2" x 1-1/2"	2.000"	50.80	1.870"	47.50	0.065"	1.65	1.500"	38.10	1.370"	34.80	0.065"	1.65	2.000"	50.80
DMI 32W 25X5	2 - 1/2" x 1/2"	2.500"	63.50	2.370"	60.20	0.065"	1.65	0.500"	12.70	0.370"	9.40	0.065"	1.65	6.500"	165.10
DMI 32W 25X7	2 - 1/2" x 3/4"	2.500"	63.50	2.370"	60.20	0.065"	1.65	0.750"	19.05	0.620"	15.75	0.065"	1.65	6.000"	152.40
DMI 32W 25X10	2 - 1/2" x 1"	2.500"	63.50	2.370"	60.20	0.065"	1.65	1.000"	25.40	0.870"	22.10	0.065"	1.65	6.000"	152.40
DMI 32W 25X15	2 - 1/2" x 1-1/2"	2.500"	63.50	2.370"	60.20	0.065"	1.65	1.500"	38.10	1.370"	34.80	0.065"	1.65	4.000"	101.60
DMI 32W 25X20	2 - 1/2" x 2"	2.500"	63.50	2.370"	60.20	0.065"	1.65	2.000"	50.80	1.870"	47.50	0.065"	1.65	2.000"	50.80
DMI 32W 30X5	3" x 1/2"	3.000"	76.20	2.870"	72.90	0.065"	1.65	0.500"	12.70	0.370"	9.40	0.065"	1.65	8.500"	215.90
DMI 32W 30X7	3" x 3/4"	3.000"	76.20	2.870"	72.90	0.065"	1.65	0.750"	19.05	0.620"	15.75	0.065"	1.65	8.000"	203.20
DMI 32W 30X10	3" x 1"	3.000"	76.20	2.870"	72.90	0.065"	1.65	1.000"	25.40	0.870"	22.10	0.065"	1.65	8.000"	203.20
DMI 32W 30X15	3" 1-1/2"	3.000"	76.20	2.870"	72.90	0.065"	1.65	1.500"	38.10	1.370"	34.80	0.065"	1.65	6.000"	152.40
DMI 32W 30X20	3" x 2"	3.000"	76.20	2.870"	72.90	0.065"	1.65	2.000"	50.80	1.870"	47.50	0.065"	1.65	4.000"	101.60
DMI 32W 30X25	3" x 2-1/2"	3.000"	76.20	2.870"	72.90	0.065"	1.65	2.500"	63.50	2.370"	60.20	0.065"	1.65	2.000"	50.80
DMI 32W 40X10	4" x 1"	4.000"	101.60	3.834"	97.38	0.083"	2.11	1.000"	25.40	0.870"	22.10	0.065"	1.65	12.000"	304.80
DMI 32W 40X15	4" x 1-1/2"	4.000"	101.60	3.834"	97.38	0.083"	2.11	1.500"	38.10	1.370"	34.80	0.065"	1.65	10.000"	254.00
DMI 32W 40X20	4" x 2"	4.000"	101.60	3.834"	97.38	0.083"	2.11	2.000"	50.80	1.870"	47.50	0.065"	1.65	8.000"	203.20
DMI 32W 40X25	4" x 2-1/2"	4.000"	101.60	3.834"	97.38	0.083"	2.11	2.500"	63.50	2.370"	60.20	0.065"	1.65	6.000"	152.40
DMI 32W 40X30	4" x 3"	4.000"	101.60	3.834"	97.38	0.083"	2.11	3.000"	76.20	2.870"	72.90	0.065"	1.65	4.000"	101.60
DMI 32W 60X20	6" x 2"	6.000"	152.40	5.782"	146.86	0.109"	2.77	2.000"	50.80	1.870"	47.50	0.065"	1.65	5.500"	139.70
DMI 32W 60X30	6" x 3"	6.000"	152.40	5.782"	146.86	0.109"	2.77	3.000"	76.20	2.870"	72.90	0.065"	1.65	5.500"	139.70
DMI 32W 60X40	6" x 4"	6.000"	152.40	5.782"	146.86	0.109"	2.77	4.000"	101.60	3.834"	97.38	0.083	2.11	5.500"	139.70

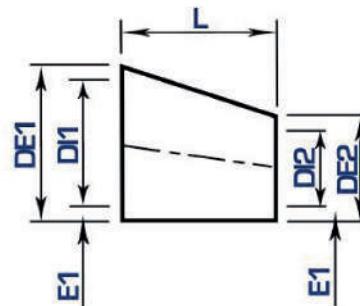



CONEXIONES SANITARIAS SOLDABLES E INOXIDABLES

14PR (Corta)
14PRL (Larga)

Férula Cónica Unión ACME
 Tipo 304 / 316L

CLAVE	TAMAÑO NOMINAL	DE		DI		E		A	
		inche	mm	inche	mm	inche	mm	inche	mm
DMI 14PR 10	1"	1.000"	25.40	0.870"	22.10	0.065"	1.65	1.310"	33.27
DMI 14PR 15	1-1/2"	1.500"	38.10	1.370"	34.80	0.065"	1.65	1.840"	46.74
DMI 14PR 20	2"	2.000"	50.80	1.870"	47.50	0.065"	1.65	2.390"	60.45
DMI 14PR 25	2-1/2"	2.500"	63.50	2.370"	60.20	0.065"	1.65	2.910"	73.91
DMI 14PR 30	3"	3.000"	76.20	2.870"	72.90	0.065"	1.65	3.440"	87.38
DMI 14PR 40	4"	4.000"	101.60	3.834"	97.38	0.083"	2.11	4.500"	114.30

L Ferula Larga: 1 - 1/8

Corta:

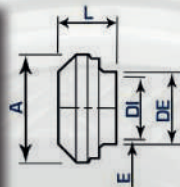

Larga:

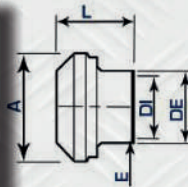

15TR (Corta)
15TRL (Larga)

Ferrula Roscada Macho ACME
 Tipo 304 / 316L

CLAVE	TAMAÑO NOMINAL	DE		DI		E		A
		inche	mm	inche	mm	inche	mm	
DMI 15TR 10	1"	1.000"	25.40	0.870"	22.10	0.065"	1.65	RD 1.5" x 1/8"
DMI 15TR 15	1-1/2"	1.500"	38.10	1.370"	34.80	0.065"	1.65	RD 2.0" x 1/8"
DMI 15TR 20	2"	2.000"	50.80	1.870"	47.50	0.065"	1.65	RD 2.5" x 1/8"
DMI 15TR 25	2-1/2"	2.500"	63.50	2.370"	60.20	0.065"	1.65	RD 3.1" x 1/8"
DMI 15TR 30	3"	3.000"	76.20	2.870"	72.90	0.065"	1.65	RD 3.6" x 1/8"
DMI 15TR 40	4"	4.000"	101.60	3.834"	97.38	0.083"	2.11	RD 4.7" x 1/8"

L Ferula Larga: 1 - 1/8

Corta:

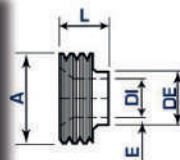

Larga:

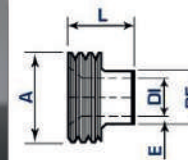



CONEXIONES SANITARIAS SOLDABLES E INOXIDABLES

Ferula Expander **14R** Tipo 304 / 316L

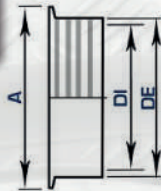

CLAVE	TAMAÑO NOMINAL	DE		DI		A	
		inche	mm	inche	mm		
DMI 14R 10	1"	1.000"	25.40	1.310"	33.27	1.988"	50.5
DMI 14R 15	1-1/2"	1.500"	38.10	1.840"	46.74	1.988"	50.5
DMI 14R 20	2"	2.000"	50.80	2.380"	60.45	2.519"	64.0
DMI 14R 25	2-1/2"	2.500"	63.50	2.910"	73.91	3.051"	77.5
DMI 14R 30	3"	3.000"	76.20	3.440"	87.38	3.582"	91.0
DMI 14R 40	4"	4.000"	101.60	4.500"	114.30	4.685"	119.0

Tuerca Unión Completa SMS **SMSUNSET** Tipo 304

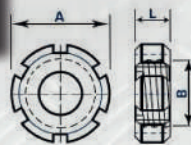

CLAVE	TAMAÑO NOMINAL	A		B		C		L	
		inche	mm	inche	mm	inche	mm	inche	mm
DMI SMSUNSET 10	1"	2.008"	51.00	1.260"	32.00	RD 40 x 1/8"	0.748"	19.00	
DMI SMSUNSET 15	1-1/2"	2.913"	74.00	1.890"	48.00	RD 60 x 1/8"	0.903"	23.00	
DMI SMSUNSET 20	2"	3.307"	84.00	2.382"	60.50	RD 70 x 1/8"	0.945"	24.00	
DMI SMSUNSET 25	2-1/2"	3.937"	100.00	2.913"	74.00	RD 85 x 1/8"	1.102"	28.00	
DMI SMSUNSET 30	3"	4.488"	114.00	3.425"	87.00	RD 98 x 1/8"	1.181"	30.00	
DMI SMSUNSET 40	4"	5.039"	128.00	4.449"	113.00	RD 125 x 1/8"	1.220"	31.00	

Tuerca Hexagonal Unión ACME **13H** Tipo 304 / 316L

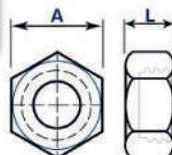

CLAVE	TAMAÑO NOMINAL	A		L	
		inche	mm	inche	mm
DMI 13H 10	1"	1.810"	45.97	0.910"	23.11
DMI 13H 15	1-1/2"	2.410"	61.21	0.970"	24.64
DMI 13H 20	2"	3.000"	76.20	1.060"	26.92
DMI 13H 25	2-1/2"	3.590"	91.19	1.190"	30.23
DMI 13H 30	3"	4.190"	106.43	1.280"	32.51
DMI 13H 40	4"	5.440"	138.18	1.500"	38.10



CONEXIONES SANITARIAS SOLDABLES E INOXIDABLES

14MPHR

Adaptador CLAMP Espiga p/ Manguera Tipo 304

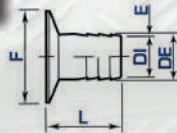

CLAVE	TAMAÑO NOMINAL	DE		DI		E		L		F	
		inche	mm	inche	mm	inche	mm	inche	mm	inche	mm
DMI 14MPHR 5	1/2"	0.500"	12.70	0.370"	9.40	0.065"	1.65	2.000"	50.80	1.000"	25.40
DMI 14MPHR 7	3/4"	0.750"	19.05	0.620"	15.75	0.065"	1.65	2.000"	50.80	1.000"	25.40
DMI 14MPHR 10	1"	1.000"	25.40	0.870"	22.10	0.065"	1.65	2.500"	63.50	1.984"	50.39
DMI 14MPHR 15	1-1/2"	1.500"	38.10	1.370"	34.80	0.065"	1.65	2.500"	63.50	1.984"	50.39
DMI 14MPHR 20	2"	2.000"	50.80	1.870"	47.50	0.065"	1.65	2.500"	63.50	2.516"	63.91
DMI 14MPHR 25	2-1/2"	2.500"	63.50	2.370"	60.20	0.065"	1.65	3.000"	76.20	3.047"	77.39
DMI 14MPHR 30	3"	3.000"	76.20	2.870"	72.90	0.065"	1.65	3.000"	76.20	3.579"	90.91

21MP

Adaptador CLAMP Rosca NPT Macho Tipo 304

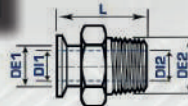

CLAVE	TAMAÑO NOMINAL	DE1		DI1		DE2		DI2		L	
		inche	mm	inche	mm	inche	mm	inche	mm	inche	mm
DMI 21MP 5	1/2"	0.500"	12.70	0.370"	9.40	0.840"	21.34	0.546"	13.87	2.000"	50.80
DMI 21MP 7	3/4"	0.750"	19.05	0.620"	15.75	1.050"	26.67	0.742"	18.85	2.000"	50.80
DMI 21MP 10	1"	1.000"	25.40	0.870"	22.10	1.315"	33.40	0.957"	24.31	2.250"	57.15
DMI 21MP 15	1-1/2"	1.500"	38.10	1.370"	34.80	1.900"	48.26	1.500"	38.10	2.440"	61.96
DMI 21MP 20	2"	2.000"	50.80	1.870"	47.50	2.375"	60.33	1.939"	49.25	2.660"	67.56
DMI 21MP 25	2-1/2"	2.500"	63.50	2.370"	60.20	2.875"	73.03	2.323"	59.00	3.280"	83.31
DMI 21MP 30	3"	3.000"	76.20	2.870"	72.90	3.500"	88.90	2.900"	73.66	3.500"	88.90
DMI 21MP 40	4"	4.000"	101.60	3.834"	97.38	4.600"	114.30	3.826"	97.77	3.810"	96.77

22MP

Adaptador CLAMP Rosca NPT Hembra Tipo 304

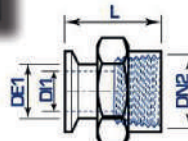

CLAVE	TAMAÑO NOMINAL	DE1		DI1		DN2		L	
		inche	mm	inche	mm	inche	mm	inche	mm
DMI 22MP 5	1/2"	0.500"	12.70	0.370"	9.40	0.840"	21.34	2.000"	50.80
DMI 22MP 7	3/4"	0.750"	19.05	0.620"	15.75	1.050"	26.67	2.125"	53.98
DMI 22MP 10	1"	1.000"	25.40	0.870"	22.10	1.315"	33.40	1.625"	41.28
DMI 22MP 15	1-1/2"	1.500"	38.10	1.370"	34.80	1.900"	48.26	2.250"	57.15
DMI 22MP 20	2"	2.000"	50.80	1.870"	47.50	2.375"	60.33	2.340"	59.44
DMI 22MP 25	2-1/2"	2.500"	63.50	2.370"	60.20	2.875"	73.03	2.620"	66.55
DMI 22MP 30	3"	3.000"	76.20	2.870"	72.90	3.500"	88.90	2.880"	73.15
DMI 22MP 40	4"	4.000"	101.60	3.834"	97.38	4.500"	114.30	3.000"	76.20



MÁS TUBERÍAS Y ACEROS DE TOLUCA

722 508 0577 - 722 208 6618
 mastuberiasyaceros@gmail.com
 mastuberiasyacerosdetoluca.com.mx



CONEXIONES SANITARIAS SOLDABLES E INOXIDABLES

Abrazadera CLAMP Dos Piezas Tipo 304 **13MHH**

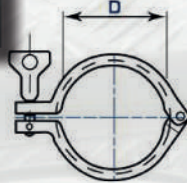

CLAVE	TAMAÑO NOMINAL	D		Presión Máx 38°C		Presión Máx 121°C	
		inche	mm	psig	Kg/cm ²	psig	Kg/cm ²
DMI 13MHH 5=7	1/2"=3/4"	1.125"	28.58	200	14.1	165	11.6
DMI 13MHH 10=15	1"=1-1/2"	2.125"	53.98	200	14.1	165	11.6
DMI 13MHH 20	2"	2.656"	67.47	200	14.1	165	11.6
DMI 13MHH 25	2-1/2"	3.185"	80.90	200	14.1	165	11.6
DMI 13MHH 30	3"	3.719"	94.46	200	14.1	150	10.5
DMI 13MHH 40	4"	4.820"	122.43	200	14.1	125	8.8
DMI 13MHH 60	6"	6.695"	170.05	150	10.5	75	5.3

Referencia: ASME BPE-2005, Tabla DT-2 Hygienic Unions

Abrazadera CLAMP Alta Presión Tipo 304 **13MHP**

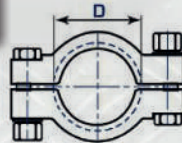
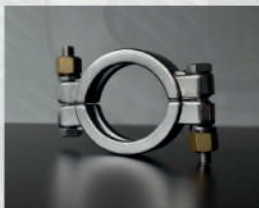

CLAVE	TAMAÑO NOMINAL	D		Presión Máx 38°C		Presión Máx 121°C	
		inche	mm	psig	Kg/cm ²	psig	Kg/cm ²
DMI 13MHP 10=15	1"=1-1/2"	2.046"	51.97	1500	105.5	1200	84.4
DMI 13MHP 20	2"	2.578"	65.48	1000	70.3	800	56.3
DMI 13MHP 25	2-1/2"	3.110"	78.99	1000	70.3	800	56.3
DMI 13MHP 30	3"	3.640"	92.46	1000	70.3	800	56.3
DMI 13MHP 40	4"	4.744"	120.50	1000	70.3	800	56.3

Referencia: ASME BPE-2005, Tabla DT-2 Hygienic Unions

Soporte Hexagonal c/a Goma Tipo 304 **24FCF**

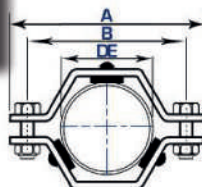

CLAVE	TAMAÑO NOMINAL	D		A		B	
		inche	mm	inche	mm	inche	mm
DMI 24FCF 10	1"	1.000"	25.40	3.750"	95.25	3.000"	76.20
DMI 24FCF 15	1-1/2"	1.500"	38.10	3.750"	95.25	3.000"	76.20
DMI 24FCF 20	2"	2.000"	50.80	4.312"	109.52	3.562"	90.47
DMI 24FCF 25	2-1/2"	2.500"	63.50	4.875"	123.83	4.187"	106.35
DMI 24FCF 30	3"	3.000"	76.20	5.500"	139.70	4.750"	120.65
DMI 24FCF 40	4"	4.000"	101.60	6.546"	166.27	5.796"	147.22

Referencia: ASME BPE-2005, Tabla DT-2 Hygienic Unions



CONEXIONES SANITARIAS SOLDABLES E INOXIDABLES

OMEGA

Soporte OMEGA
Tipo 304



CLAVE	TAMAÑO NOMINAL	DE	
		inche	mm
DMI OMEGA 5	1/2"	0.500"	12.70
DMI OMEGA 7	3/4"	0.750"	19.05
DMI OMEGA 10	1"	1.000"	25.40
DMI OMEGA 15	1-1/2"	1.500"	38.10
DMI OMEGA 20	2"	2.000"	50.80
DMI OMEGA 25	2-1/2"	2.500"	63.50
DMI OMEGA 30	3"	3.000"	76.20
DMI OMEGA 40	4"	4.000"	101.60

VMMP

Válvula Mariposa CLAMP
Tipo 304 / 316L

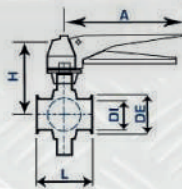

CLAVE	TAMAÑO NOMINAL	DE		DI		L	H		A		
		inche	mm	inche	mm		inche	mm			
DMI VMMP 10	1"	1.984"	50.4	0.986"	22.1	2.520"	64	3.230"	82	5.905"	150
DMI VMMP 15	1-1/2"	1.984"	50.4	1.370"	34.8	2.835"	72	3.425"	87	5.905"	150
DMI VMMP 20	2"	2.520"	64.0	1.870"	47.5	2.835"	72	3.680"	93.5	5.905"	150
DMI VMMP 25	2-1/2"	3.050"	77.5	2.370"	60.2	2.962"	76	3.680"	93.5	5.905"	150
DMI VMMP 30	3"	3.616"	91.9	2.870"	72.9	2.962"	76	4.015"	102	5.905"	150
DMI VMMP 40	4"	4.670"	118.9	3.835"	97.4	4.065"	104	4.705"	119.5	5.905"	150

VCHW

Válvula Mariposa Soldable
Tipo 304 / 316L

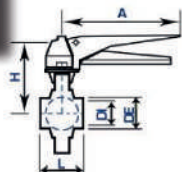

CLAVE	TAMAÑO NOMINAL	DE		DI		L	H		A		
		inche	mm	inche	mm		inche	mm			
DMI VMW 10	1"	1.000"	25.4	0.986"	22.1	1.575"	40	3.230"	82	5.905"	150
DMI VMW 15	1-1/2"	1.500"	38.1	1.370"	34.8	1.970"	50	3.425"	87	5.905"	150
DMI VMW 20	2"	2.000"	50.8	1.870"	47.5	1.970"	50	3.680"	93.5	5.905"	150
DMI VMW 25	2-1/2"	2.500"	63.5	2.370"	60.2	1.970"	50	3.680"	93.5	5.905"	150
DMI VMW 30	3"	3.000"	76.2	2.870"	72.9	1.970"	50	4.015"	102	5.905"	150
DMI VMW 40	4"	4.000"	101.3	3.835"	97.4	2.520"	64	4.705"	119.5	5.905"	150



MÁS TUBERÍAS Y ACEROS DE TOLUCA

722 508 0577 - 722 208 6618
 mastuberiasyaceros@gmail.com
 mastuberiasyacerosdetoluca.com.mx



CONEXIONES SANITARIAS SOLDABLES E INOXIDABLES

Válvula Bola CLAMP Tipo 304 / 316L **VBLMP**

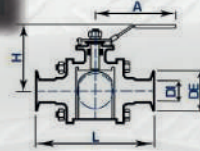

CLAVE	TAMAÑO NOMINAL	DE		DI		L		H		A	
		inche	mm	inche	mm	inche	mm	inche	mm	inche	mm
DMI VBLMP 5	1/2"	1.000"	25.4	0.370"	9.40	3.490"	89.6	2.051"	52.1	3.937"	100.00
DMI VBLMP 7	3/4"	1.000"	25.4	0.620"	15.75	4.045"	102.7	2.280"	57.9	5.197"	132.00
DMI VBLMP 10	1"	1.984"	50.4	0.870"	22.10	4.535"	115.2	2.441"	62	5.197"	132.00
DMI VBLMP 15	1-1/2"	1.984"	50.4	1.370"	34.80	5.508"	139.9	3.858"	98	6.890"	175.00
DMI VBLMP 20	2"	2.520"	63.9	1.870"	47.50	6.225"	158.1	3.001"	103.9	6.890"	175.00
DMI VBLMP 25	2-1/2"	3.050"	77.5	2.370"	60.20	7.800"	198.2	5.551"	141	10.236"	260.00
DMI VBLMP 30	3"	3.580"	90.9	2.870"	72.90	8.956"	227.5	6.008"	154.9	10.236"	260.00
DMI VBLMP 40	4"	4.680"	118.9	3.834"	97.38	9.527"	242	6.890"	175	10.236"	260.00

Válvula Check Tipo 304 / 316L **VCMP**

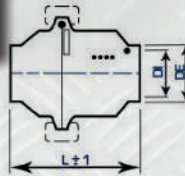
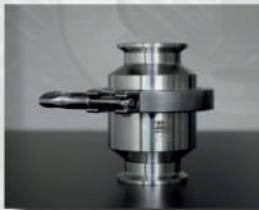

CLAVE	TAMAÑO NOMINAL	DE		DI		L	
		inche	mm	inche	mm	inche	mm
DMI VCHW 10	1"	1.000"	25.40	0.870"	22.1	2.362"	60
DMI VCHW 15	1-1/2"	1.500"	38.10	1.370"	34.8	2.953"	75
DMI VCHW 20	2"	2.000"	50.80	1.870"	47.5	2.953"	75
DMI VCHW 25	2-1/2"	2.500"	63.50	2.370"	60.2	2.953"	75
DMI VCHW 30	3"	3.000"	76.20	2.870"	72.9	3.000"	76.2
DMI VCHW 40	4"	4.000"	101.60	3.835"	97.4	4.665"	118.5

Empaque para Unión CLAMP **40MP**

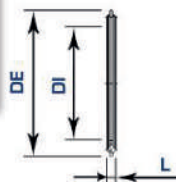

CLAVE	TAMAÑO NOMINAL	DE		DI		L	
		inche	mm	inche	mm	inche	mm
DMI 40MP 5	1/2"	1.000"	25.4	0.370"	9.4	0.177"	4.5
DMI 40MP 7	3/4"	1.000"	25.4	0.620"	15.75	0.177"	4.5
DMI 40MP 10	1"	1.984"	50.4	0.870"	22.1	0.217"	5.5
DMI 40MP 15	1-1/2"	1.984"	50.4	1.370"	34.8	0.217"	5.5
DMI 40MP 20	2"	2.516"	63.9	1.870"	47.5	0.217"	5.5
DMI 40MP 25	2-1/2"	3.050"	77.5	2.370"	60.2	0.217"	5.5
DMI 40MP 30	3"	3.579"	90.9	2.870"	72.9	0.217"	5.5
DMI 40MP 40	4"	4.680"	118.9	3.834"	97.38	0.217"	5.5
DMI 40MP 60	6"	6.571"	166.9	5.782"	146.86	0.217"	5.5

SILICÓN:
TEFLÓN (PTFE)
BUNA:

Temperatura de servicio desde -50°C a +230°C, excelente resistencia a la intemperie, al vapor y aceites vegetales.
 Temperatura de servicio desde -40°C a +230°C, excelente resistencia a la corrosión, al vapor, aceites vegetales, ácidos, petroquímicos, ozono, y la abrasión, aprobado por FDA y USDA.
 Temperatura de servicio desde -40°C a +100°C, excelente resistencia a petroquímicos y aceites vegetales, buena resistencia a los ácidos y bases.



MÁS TUBERÍAS Y ACEROS DE TOLUCA

722 508 0577 - 722 208 6618
 mastuberiasyaceros@gmail.com
 mastuberiasyacerosdetoluca.com.mx



CONEXIONES SANITARIAS SOLDABLES E INOXIDABLES

BRIDASANSO

Brida Sanitaria Slip-On Tipo 304

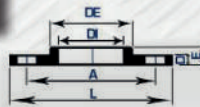
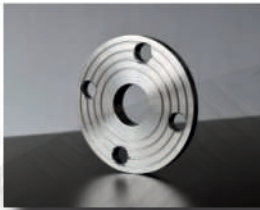

CLAVE	TAMAÑO NOMINAL	DE	DI	L	A	D	E
		mm	mm	mm	mm	mm	mm
DMI BRIDASANSO 10	1"	1.987	46.2	1.015	25.7	4.250	107.9
DMI BRIDASANSO 13	1-1/4"	2.912	56.7	1.283	32.1	4.625	117.4
DMI BRIDASANSO 15	1-1/2"	2.952	65.09	1.515	38.4	5.000	127
DMI BRIDASANSO 20	2"	3.062	77.7	2.015	51.1	6.000	152.4
DMI BRIDASANSO 25	2-1/2"	3.582	90.4	2.515	63.8	7.000	177.8
DMI BRIDASANSO 30	3"	4.250	107.9	3.015	76.5	7.500	190.5
DMI BRIDASANSO 40	4"	5.312	134.9	4.015	101.9	9.000	228.6
DMI BRIDASANSO 60	6"	7.750	196.8	6.015	152.7	11.000	279.4
DMI BRIDASANSO 80	8"	9.687	240.06	8.032	203.5	13.000	342.9
DMI BRIDASANSO 100	10"	12.000	304.8	10.062	255.5	16.000	406.4
DMI BRIDASANSO 150	16"	18.000	457.2	16.062	407.96	23.500	596.9

54SMP

Mirilla CLAMP Tipo 304 / 316L

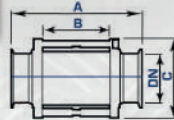

CLAVE	TAMAÑO NOMINAL	DE	DI	A	B	C
		mm	mm	mm	mm	mm
DMI 54SMP 10	1"	1.000	25.40	0.670	22.10	5.750
DMI 54SMP 15	1-1/2"	1.500	38.10	1.370	34.80	6.000
DMI 54SMP 20	2"	2.000	50.80	1.870	47.50	6.000
DMI 54SMP 25	2-1/2"	2.500	63.50	2.370	60.20	7.000
DMI 54SMP 30	3"	3.000	76.20	2.870	72.90	7.940
DMI 54SMP 40	4"	4.000	101.60	3.834	97.38	8.090

540MP

Mirilla Ojo de Buey Tipo 304 / 316L

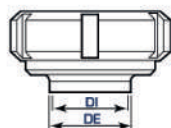
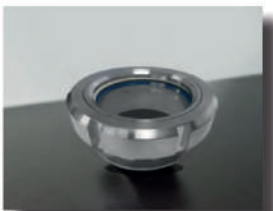

CLAVE	TAMAÑO NOMINAL	DE	DI
		mm	mm
DMI 540MP 5	1/2"	0.375	9.5
DMI 540MP 7	3/4"	0.625	15.8
DMI 540MP 10	1"	0.875	22.2
DMI 540MP 15	1-1/2"	1.375	34.9
DMI 540MP 20	2"	1.875	47.6
DMI 540MP 25	2-1/2"	2.375	60.3
DMI 540MP 30	3"	2.875	73.0
DMI 540MP 40	4"	3.812	97.4